

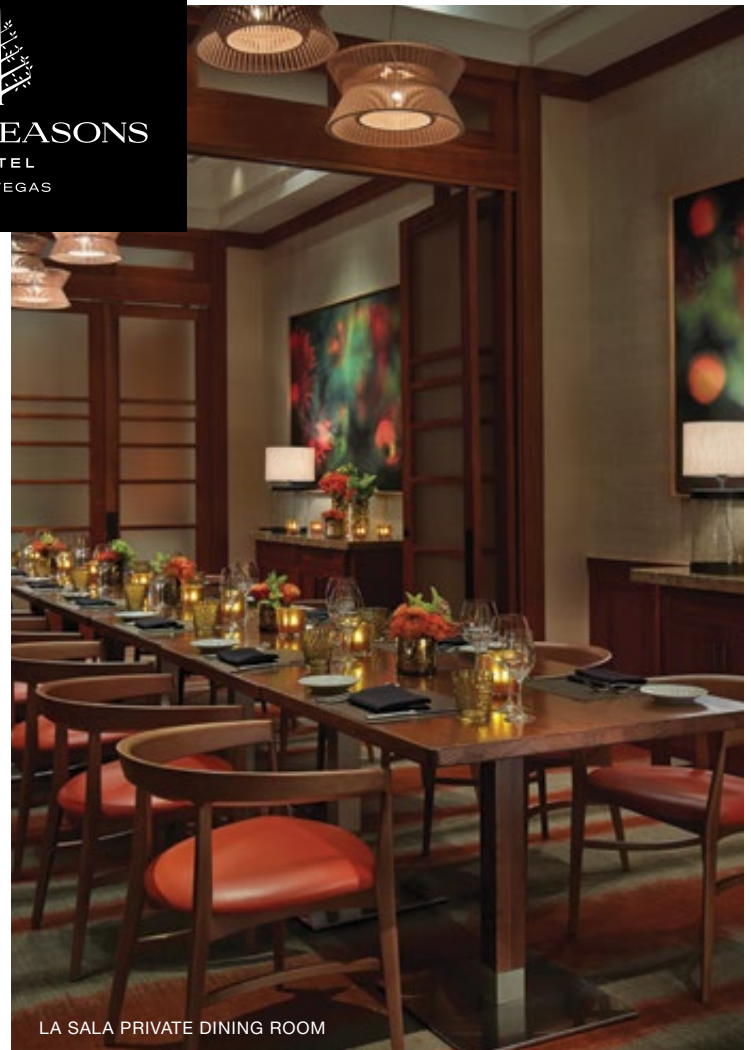

PRESS PATIO

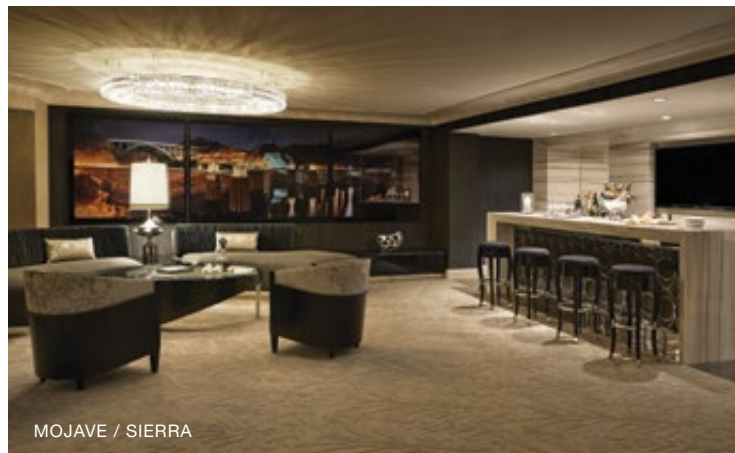

LA SALA PRIVATE DINING ROOM



MOJAVE / SIERRA

EXCLUSIVE PRIVATE DINING FOR SMALLER GROUPS

Impress your group – whether friends, family or business colleagues – with an unforgettable dining experience at Four Seasons Hotel Las Vegas. Choose from beautiful indoor and outdoor venues, including hospitality suites soaring high above the city. Our intimate, relaxed atmosphere keeps the focus on your event, while attentive service creates a sophisticated Four Seasons experience.

LOCATION

- Conveniently located at the south end of the Las Vegas Strip, within the Mandalay Bay Resort complex
- Exclusive Four Seasons driveway with porte cochère and valet service, just steps from our dining venues – a rare advantage on the Las Vegas Strip

HOSPITALITY SUITES

- Two sleek, stylish suites on the 38th and 39th floors
- Ideal for welcome parties and receptions for up to 75

VERANDA PRIVATE DINING

- Two private dining rooms for 10 to 24 people
- Specializing in authentic Italian cuisine

PRESS PATIO

- A chic outdoor lounge overlooking the pool and gardens
- Comfortable sofas and chairs, set beneath twinkling trellis lighting and featuring two firepits
- Hosting 150 for receptions or 30 to 80 for dining

CABANA ONE

- Our largest and most luxurious poolside cabana with a spacious outdoor terrace
- Secluded on the south side of the pool for enhanced privacy – with views across the pool to the waterfall
- Hosting 50 for receptions or 30 for dining

TO BOOK YOUR NEXT EVENT, PLEASE CONTACT THE CATERING DEPARTMENT AT

Tel: (702) 632-5210

Email: vgs.catering@fourseasons.com

CONNECT WITH US

fourseasons.com/lasvegas



FSVGS280001e / 12/2017

LOBBY LEVEL

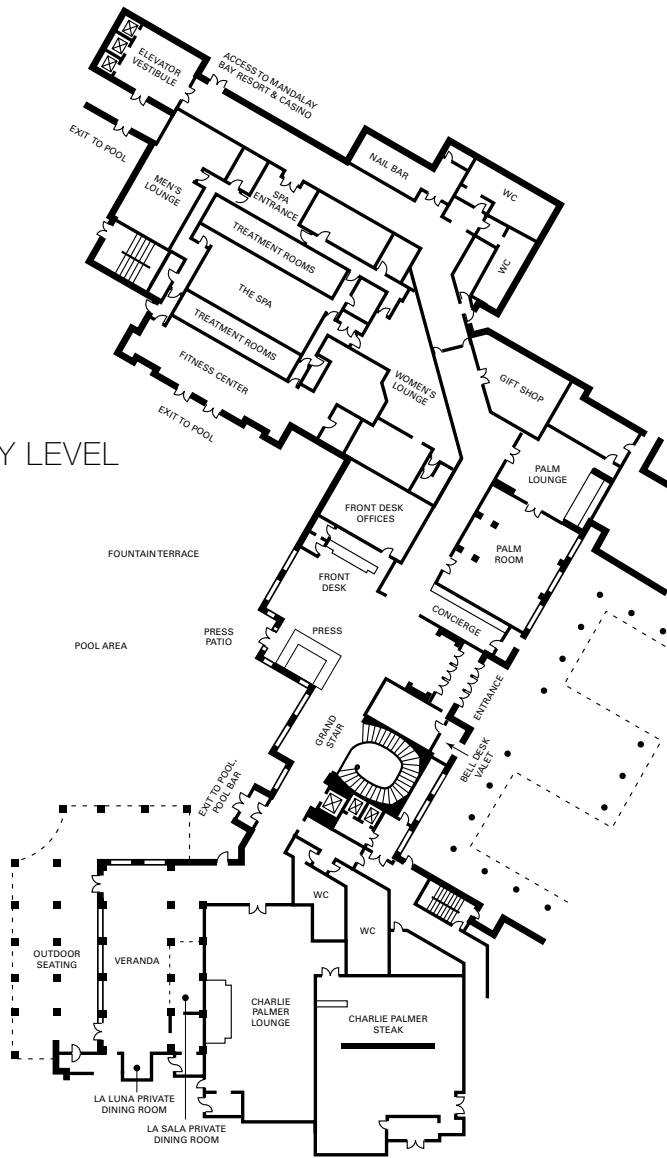

SECOND FLOOR

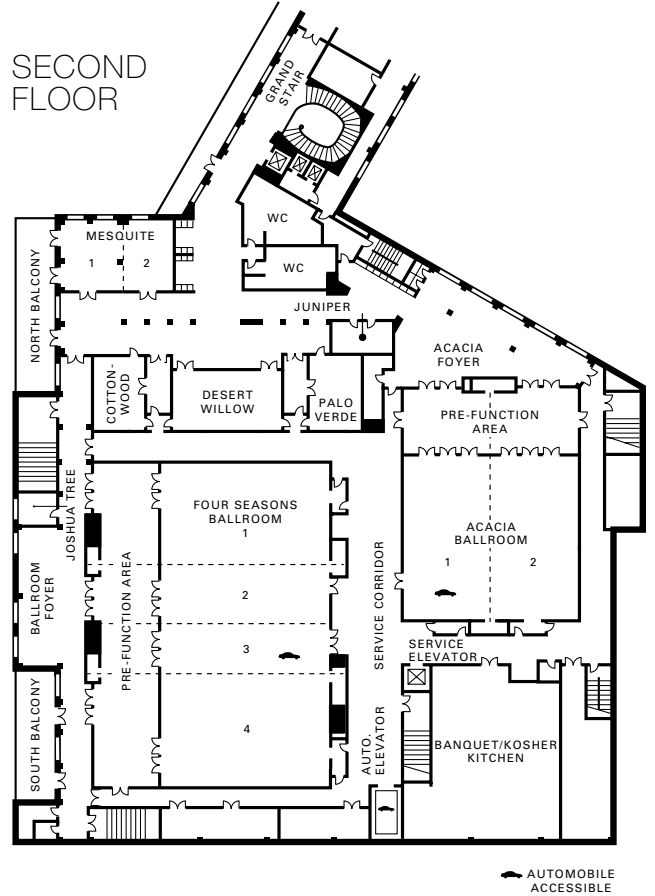

CAPACITIES

ROOM	Size (sq. ft.)	Size (m ²)	Rounds (10 pp/table)	Boardroom	Classroom	Theatre	U-shape	Hollow Square	Reception
Lobby Level									
Palm Room*	1,702	158	120	36	60	120	32	40	200
Pool*	-	-	300	-	-	-	-	-	500
Fountain Terrace*	5,950	552	300	-	-	400	-	-	400
Second Floor									
Four Seasons Ballroom	10,080	936	600	-	600	750	-	-	900
Four Seasons Pre-Function	3,920	364	200	-	-	300	-	-	240
Acacia Ballroom	5,250	487	300	-	300	380	-	-	450
Acacia Ballroom Pre-Function	1,950	181	120	-	80	136	-	-	140
Mesquite Room*	1,590	148	120	-	70	100	-	-	140
Mesquite One*	960	89	80	22	48	60	27	36	80
Mesquite Two*	630	59	40	22	24	40	24	30	60
Desert Willow	1,196	111	80	36	60	100	36	42	100
North Balcony*	852	79	-	-	-	-	-	-	60
Cottonwood	672	62	50	22	24	56	24	30	50
Palo Verde	672	62	50	22	24	56	24	30	50
Joshua Tree*	203	19	-	-	-	-	-	-	-
Juniper	228	21.2	10	8	-	-	-	-	-
Mojave Boardroom* (38th Floor)	2,100	195	-	14	-	-	-	-	75
Sierra Boardroom* (39th Floor)	2,100	195	-	14	-	-	-	-	75

*Indicates function rooms with natural light or outdoor space.